

## GRAPHITE GASKET TYPE CIRCULAR JIS B2220 - 10K

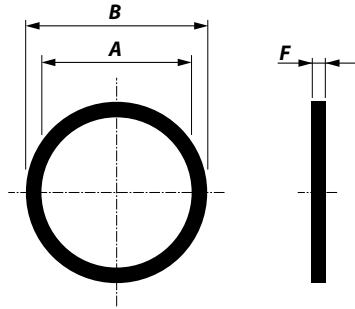

| Article No.  | Size (Inch) | NB (mm) | Pipe (mm) | A (mm) | B (mm) | F (mm) | Weight (kg) |
|--------------|-------------|---------|-----------|--------|--------|--------|-------------|
| 213350030010 | 1           | 25      | 34.5      | 35     | 90     | 2      | 0.1         |
| 213350030013 | 1.25        | 32      | 43.2      | 43     | 100    | 2      | 0.1         |
| 213350030015 | 1.5         | 40      | 49.1      | 49     | 105    | 2      | 0.1         |
| 213350030020 | 2           | 50      | 61.1      | 61     | 120    | 2      | 0.1         |
| 213350030025 | 2.5         | 65      | 77.1      | 77     | 140    | 2      | 0.2         |
| 213350030030 | 3           | 80      | 90.0      | 90     | 150    | 2      | 0.2         |
| 213350030040 | 4           | 100     | 115.4     | 116    | 175    | 2      | 0.2         |
| 213350030050 | 5           | 125     | 141.2     | 142    | 210    | 2      | 0.2         |
| 213350030060 | 6           | 150     | 166.6     | 167    | 240    | 2      | 0.3         |
| 213350030080 | 8           | 200     | 218.0     | 218    | 290    | 2      | 0.3         |
| 213350030100 | 10          | 250     | 269.5     | 270    | 355    | 2      | 0.3         |
| 213350030120 | 12          | 300     | 321.0     | 321    | 400    | 2      | 0.3         |
| 213350030140 | 14          | 350     | 358.1     | 358    | 445    | 2      | 0.4         |
| 213350030160 | 16          | 400     | 409.0     | 409    | 510    | 2      | 0.4         |
| 213350030180 | 18          | 450     | 460.0     | 460    | 565    | 2      | 0.4         |
| 213350030200 | 20          | 500     | 511.0     | 511    | 620    | 2      | 0.5         |
| 213350030240 | 24          | 600     | 613.0     | 613    | 730    | 2      | 0.8         |
| 213350030280 | 28          | 700     | 715.0     | 715    | 840    | 2      | 0.8         |
| 213350030320 | 32          | 800     | 817.0     | 817    | 950    | 2      | 0.8         |
| 213350030360 | 36          | 900     | 919.0     | 919    | 1050   | 2      | 1           |
| 213350030400 | 40          | 1000    | 1021.0    | 1021   | 1160   | 2      | 1           |

### CHARACTERISTICS

**Material** Gaskets are produced out of graphite

**Range** Diameter range from 34.5 mm up to 1021 mm

**Thickness** 2 mm, with an option for 3 and 4 mm

**Temperature** The maximum allowable temperature is 600°C